



### TECHNICAL DATA:

Not easy accessible device,  
according to standard EN 1176-1:2017

Device dimensions:	3,44 x 4,91m
Device height:	3,00m
Minimum space:	6,25 x 7,63m
Falling area:	39,22m <sup>2</sup>
Critical fall height:	1,70m
Foundations depth:	-0,60m

The device according to EN 1176-1:2017  
Playground equipment and surfacing – Part 1:  
General safety requirements and test methods

Safety surfaces:  
- sand, gravel, bark, synthetic surface  
- minimal thickness for loose particulate materials 200+100mm  
- synthetic surface according to critical fall height

### Top view with falling area

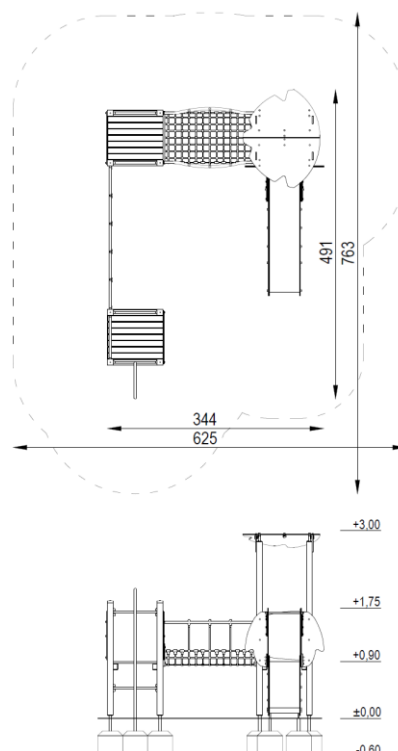

## COMPONENTS:

Tower without roof, platform 90cm:	2 pcs
Tower with roof, platform 90cm:	1 pc
Vertical ladder:	3 pcs
Slide 90cm:	1 pc
Fireman's pole 90cm:	1 pc
Rope bridge:	1 pc
Vertical rope net:	1 pc

## MATERIALS:

Construction poles:	glued laminated pine timber, rounded at the edges, varnish painted dark brown
Anchors:	galvanized steel
Flat decorative elements:	HDPE sheets,
Platforms, gangways:	impregnated pinewood boards, with machined anti-skid surface,
Steel elements:	galvanized steel, powder coated
Ropes:	polypropylene braided with a steel, interconnected by plastic fasteners
Surface of slide:	stainless steel,
Caps:	plastic
Foundations:	concrete min. C12/15 standard



SATERNUS DISTRIBUTION Sp. z o.o. sp.k.  
ul. Nowa 32  
41-500 Chorzów, Poland

Certificate beholder:  
Producer:  
Distributor:

GRUPA SATERNUS Sp. z o.o. S. K. A. reserves all rights to protect copyright under the Act of February 4, 1994 on Copyright and Related Rights (Journal of Laws No. 28, item 83), and in particular Art. 78 and 79 of this Law.

GRUPA SATERNUS Sp. z o.o. S. K. A.  
Saternus Production Sp. z o.o. sp. k.  
Saternus Distribution Sp. z o.o. sp. k.