



TECHNICAL DATA:

Not easy accessible device,
according to standard EN 1176-1:2017

Device dimensions:	4,62 x 5,49m
Device height:	3,25m
Minimum space:	7,62 x 8,86m
Falling area:	48,76m ²
Critical fall height:	0,90m
Foundations depth:	-0,60m

The device according to EN 1176-1:2017
Playground equipment and surfacing – Part 1:
General safety requirements and test methods

Safety surfaces:
-grass, sand, gravel, bark, synthetic surface
- minimal thickness for loose particulate materials 200+100mm
- synthetic surface according to critical fall height

Top view with falling area

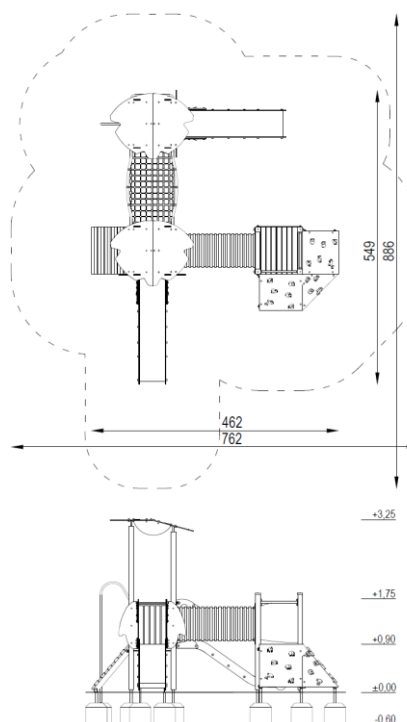

COMPONENTS:

Tower without roof, platform 0,90m:	1 pc.
Tower with roof, platform 0,90m:	2 pcs.
Corner climbing wall 0,90m:	1 pc.
Slope gangway 0,90m:	1 pc.
Slide 0,90m :	2 pcs.
Fireman's pole 0,90m:	1 pc.
Rope bridge:	1 pc.
Tunnel passage:	1 pc.
Balcony:	1 pc.

MATERIALS:

Construction poles:	glued laminated pine timber, rounded at the edges, varnish painted dark brown
Anchor:	galvanized steel
Flat decorative elements:	HDPE sheets,
Platforms, gangways:	impregnated pinewood boards, with machined anti-skid surface,
Steel elements:	galvanized steel, powder coated
Surface of slide:	stainless steel,
Climbing walls:	waterproof plywood, climbing grips, based on resins
Ropes:	polypropylene braided with a steel, interconnected by plastic fasteners
Tunnel:	PVC pipe fastened to HDPE boards
Caps:	Plastic
Foundations:	concrete min. C12/15 standard



SATERNUS DISTRIBUTION Sp. z o.o. sp.k.
ul. Nowa 32
41-500 Chorzów, Poland

Certificate beholder:
Producer:
Distributor:

GRUPA SATERNUS Sp. z o.o. S. K. A. reserves all rights to protect copyright under the Act of February 4, 1994 on Copyright and Related Rights (Journal of Laws No. 28, item 83), and in particular Art. 78 and 79 of this Law.

GRUPA SATERNUS Sp. z o.o. S. K. A.
Saternus Production Sp. z o.o. sp. k.
Saternus Distribution Sp. z o.o. sp. k.